

## Euro Profile Cylinder Door Lock MK114-32

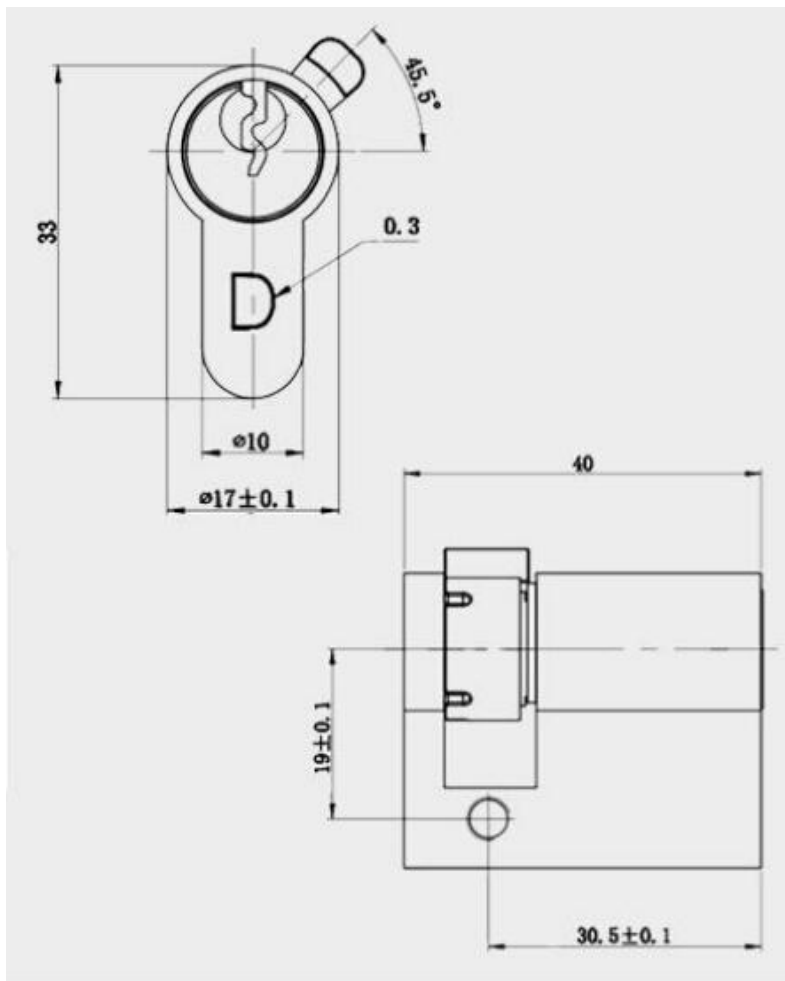

Material	Brass
Finished	Bright chrome, nickel
Key Combination	1000
Applications	Sliding door, glass door, cabinet door, metal door, folding door, etc.
Speciality	<ol style="list-style-type: none"> <li>1. Security pin tumbler system.</li> <li>2. Customer-oriented development available.</li> </ol>

Learn more Locks products on <http://www.makelocks.com/>

Copyright © Xiamen Make Locks Manufacturer Co., Limited